

## ROXBURY - ROUTE 80 COMMERCIAL PARK

### Preliminary & Final Site Plan

Roxbury, Morris County, NJ

CLIENT: Blue Vista Consulting, LLC

#### Services Provided:

- Topographic Surveying
- Master Planning/Concept Study
- Preliminary & Final Site Plan
- Landscape Architecture
- Highway/Traffic Signal Design
- Environmental Permitting

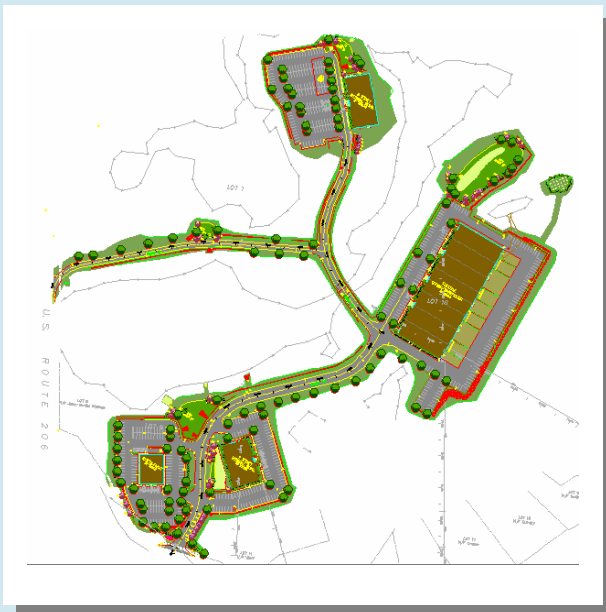

#### Project Description:

This mixed use commercial development required careful and environmentally sensitive design principles to limit impacts to extensive wetlands and flood hazard areas on this 62 acre site. In addition, extensive off-site utility design was necessary to extend sanitary sewer service to the site (>2500 feet) and potable water service (>1800 feet). The development plans for this project also included highway improvements to Route 206 to accommodate the additional traffic from the project, including a new traffic signal installation.