

ROUTE 517 BY-PASS WIDENING

Roadway Widening & Traffic Signal Construction Plans
Township of Sparta, Sussex County, NJ
CLIENT: Jersey Investors Growth

- Services Provided:**
- Existing Conditions Surveying
 - Highway/Traffic Signal Design

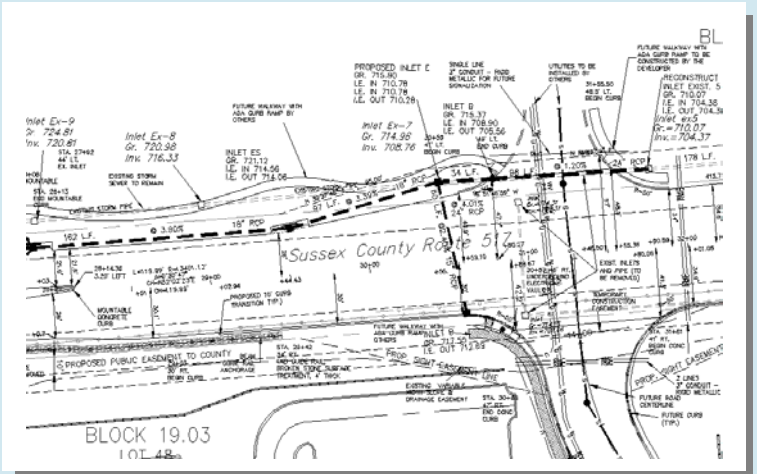

Project Description:

Widening of approximately one mile of the existing Route 517 in Sussex County. This work required to control drainage, maintain existing super-elevation of the roadway and integrate a new intersection. As part of the new four way intersection, a traffic signal system was designed. Complete detailed survey and traffic control plans and permitting with the County for the widening and signal was performed.